

A4010 & A4129 Safety Improvements Works

Post Consultation Plans

July 2019

A4010 & A4129 Safety Improvement Works

- This project has been developed in partnership with the A4010 & A4129 Petitioner Group consisting of members from Princes Risborough Town Council, Bradenham Parish Council, West Wycombe Parish Council and Wycombe District Council.



Bradenham Parish Council



A4010 & A4129 Safety Improvement Works

- Standard detailed layout of proposed entry features as part of the wider project. Speed limit is subject to location.

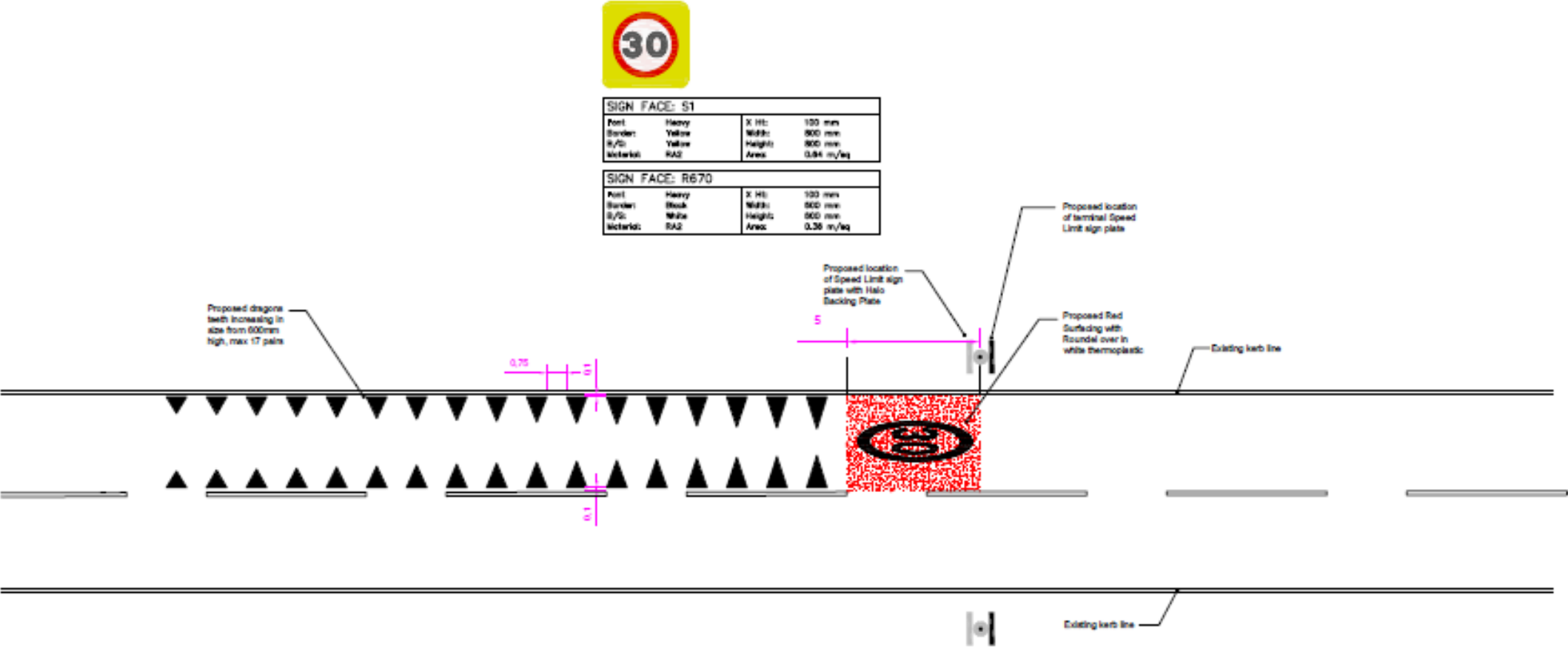

Sites 3 & 9 – A4010 Aylesbury Road

Site 9 – Monks Risborough Entry Feature

- New yellow backed speed limit signage on existing sign posts
- New Vehicle Activated Sign (VAS) 30mph positioned in urban area
- New dragons teeth and high friction surfacing (HFS) entry feature

Site 3 – Monks Risborough School Frontage

- Upgraded street lantern with 'Warm White' LED
- New yellow backed warning sign on existing sign post
- Refreshed high friction surfacing (HFS) on crossing and relining works

SITE 9

SITE 3

FOR DISCUSSION ONLY

Sites 2 & 15 – A4010 Aylesbury Road

The map displays Aylesbury Road with two project sites highlighted in orange. Site 15 is located further north, and Site 2 is located further south near a roundabout. Two inset photographs show the road from a driver's perspective: one at Site 15 and one at Site 2. The map includes labels for 'Recreation Ground', 'Area', 'AYLESBURY ROAD', 'Ker-Marla Nursing Home', and 'St Teresa's Church'. A legend on the right side of the map provides details for the proposed works at each site.

SITE 15

SITE 2

Site 15 – New Zebra Crossing

- New zebra crossing with high friction surfacing and associated signing and lining works.
- Upgraded Street Lantern with 'Warm White' LED

Site 2 – St Teresa's School Frontage

- Updated yellow backed signage on approach
- Updated Belisha Beacons
- Refreshed high friction surfacing (HFS) on crossing and relining works.
- Roundabout landscaping reduced at outer edge to improve driver visibility on approaches with low maintenance resin surfacing

Site 15 – A4010 Aylesbury Road

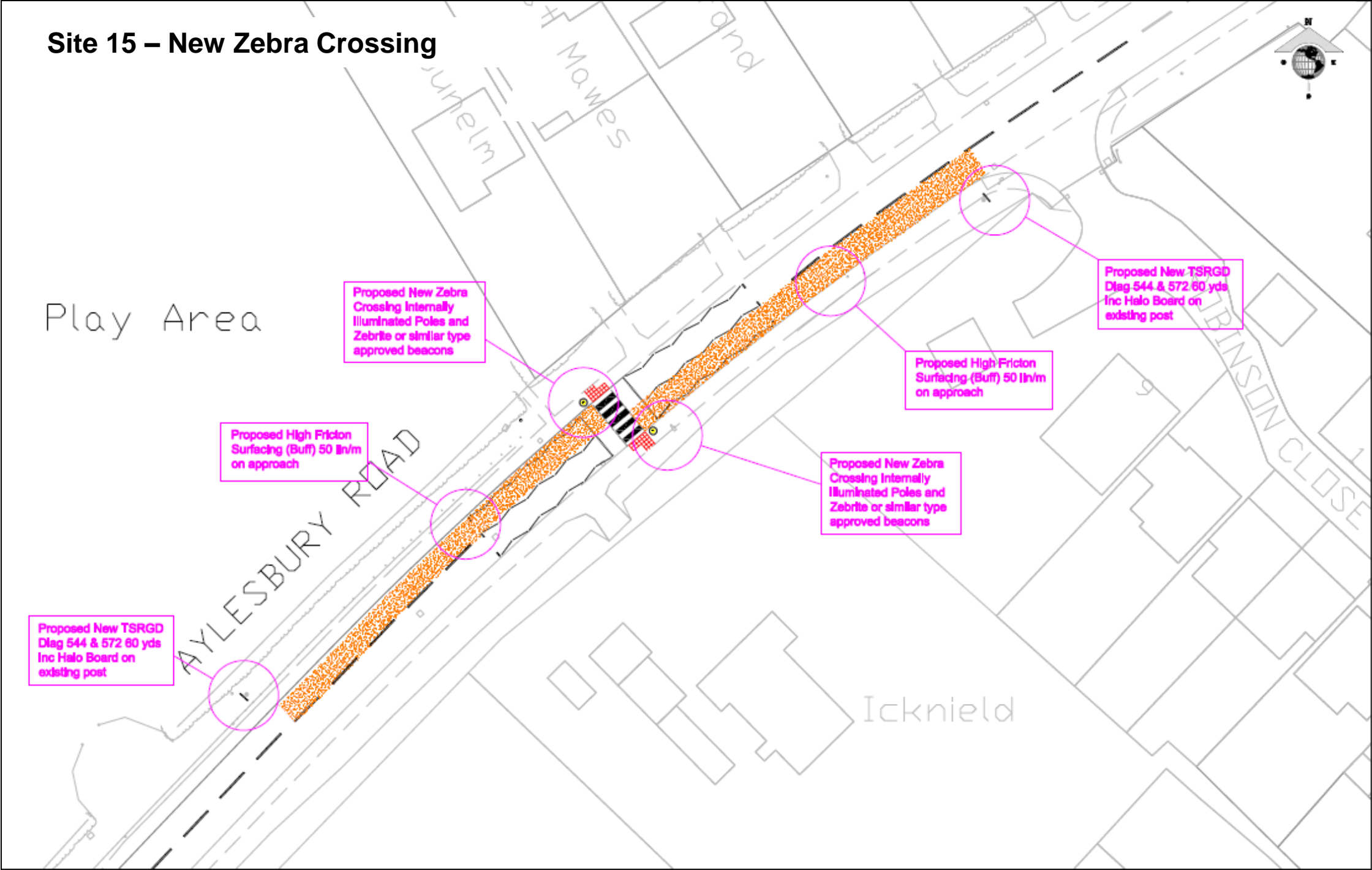

Site 6 – A4129 Longwick Road

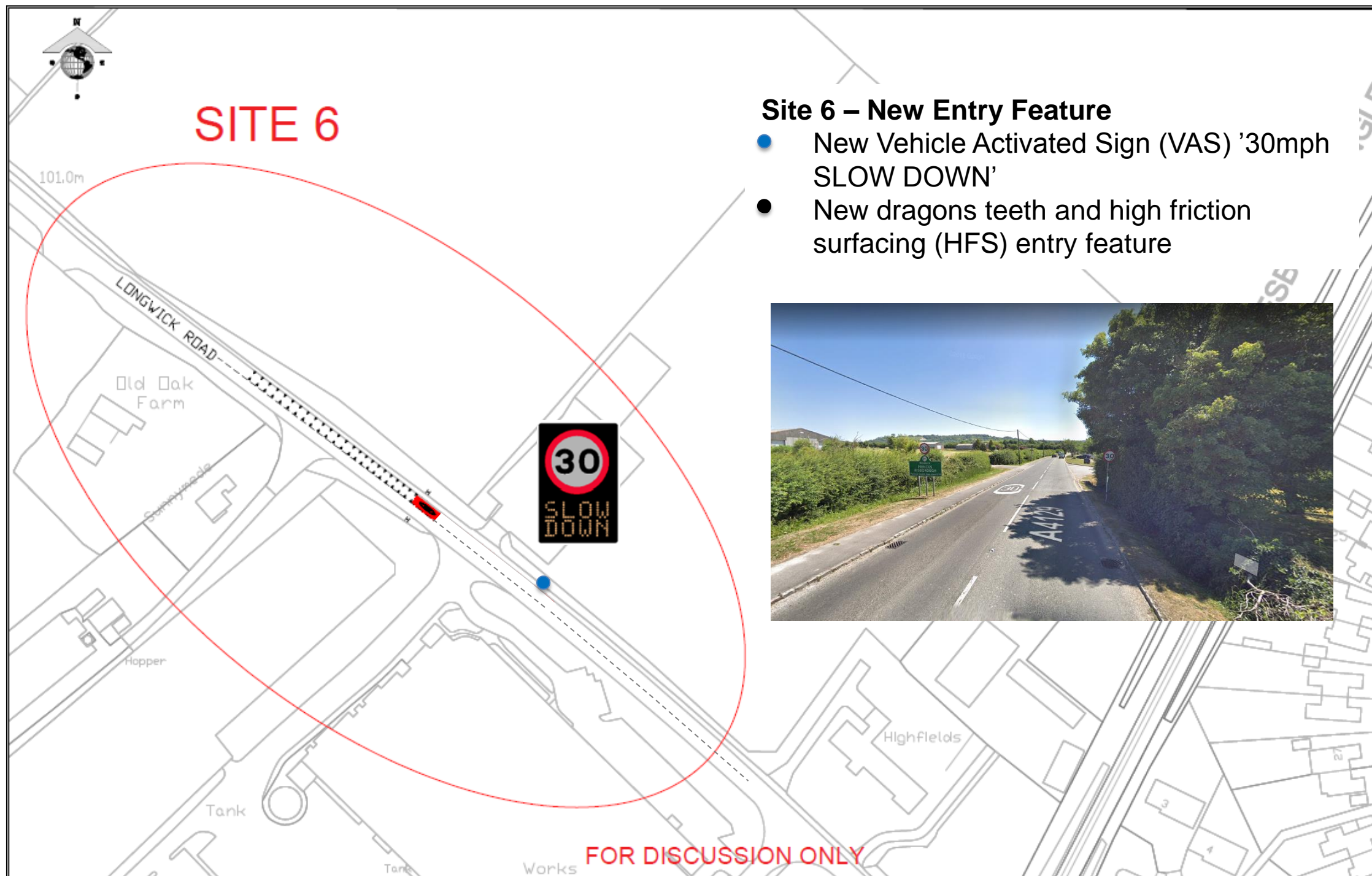

Site 6 – New Entry Feature

- New Vehicle Activated Sign (VAS) '30mph SLOW DOWN'
- New dragons teeth and high friction surfacing (HFS) entry feature



Site 7a – A4129 Longwick Road



Site 7a – Existing Pedestrian Crossing

- New yellow backed signage on existing sign posts
- Updated Belisha Beacons
- Refresh road markings



FOR DISCUSSION ONLY

Site 7b – A4010 New Road

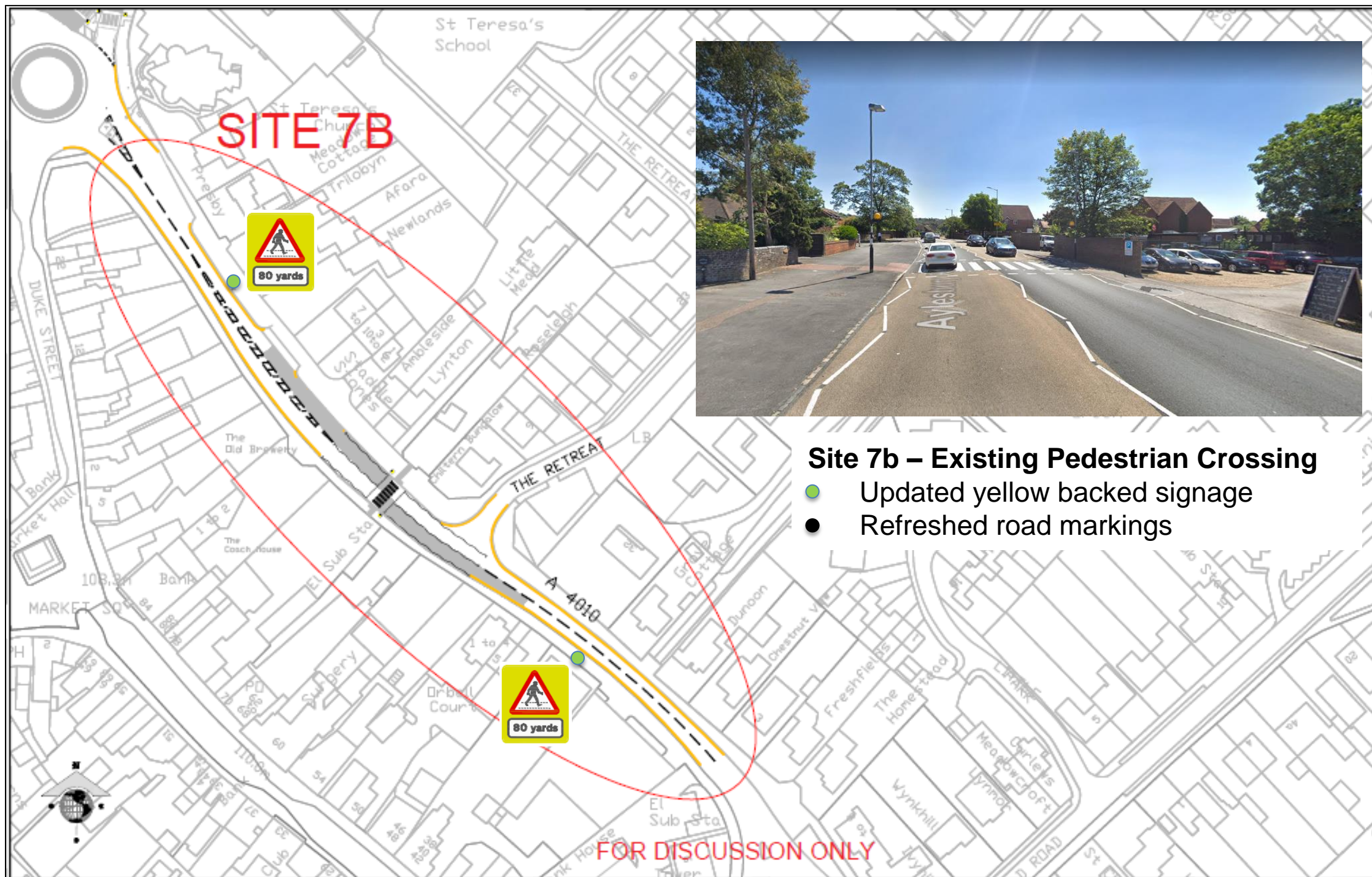

Site 7b – Existing Pedestrian Crossing

- Updated yellow backed signage
- Refreshed road markings

Site 5 – A4010 Wycombe Road

Site 5 – New Zebra Crossing & Traffic Islands

- New zebra crossing with High Friction Surfacing (HFS) and associated signing and lining works.
- New pedestrian refuge island with retro reflective signage and bollards east of Station Road junction
- New traffic island west of Station Road junction

Examples of a traffic island and pedestrian refuge

FOR DISCUSSION ONLY

Site 5 – A4010 Wycombe Road

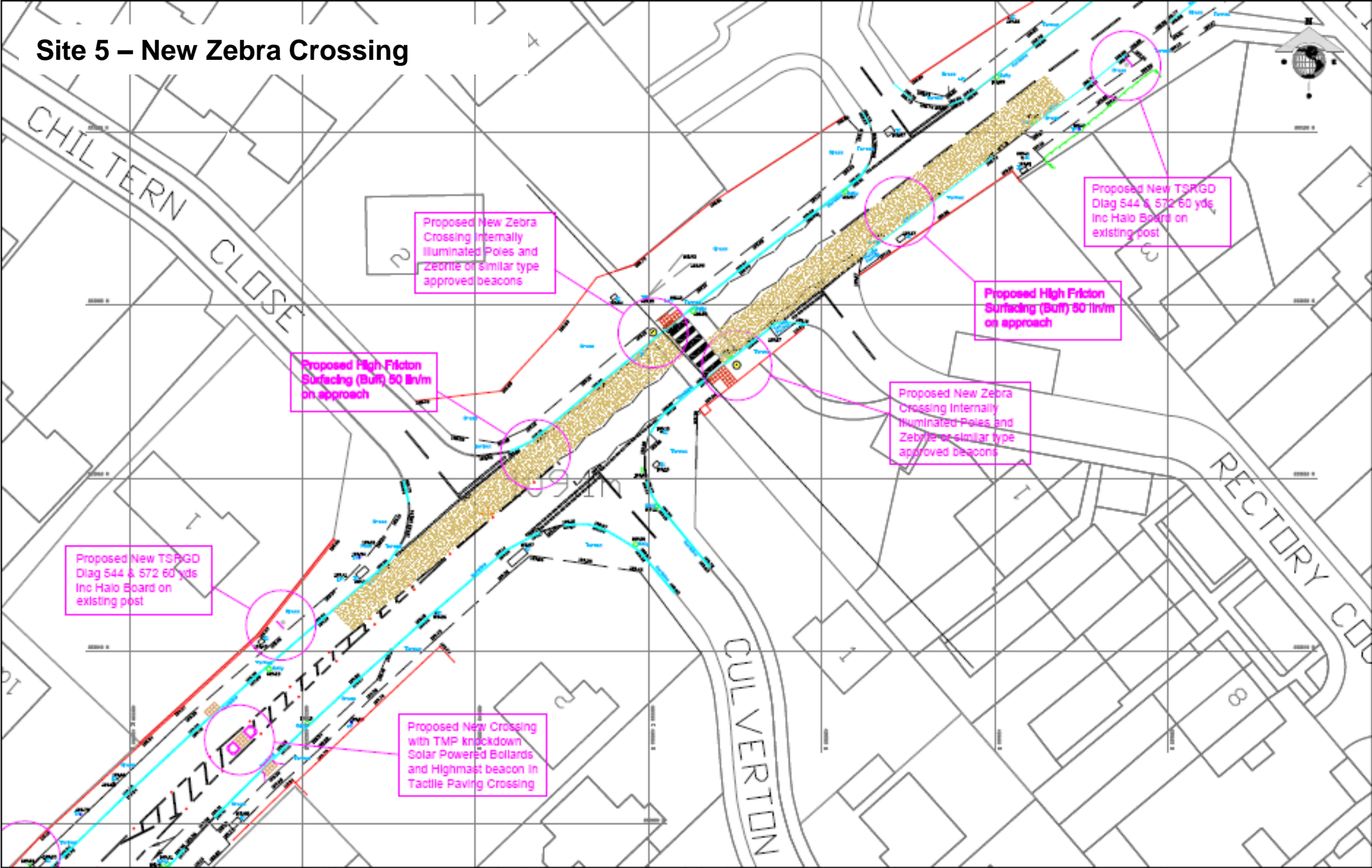

Site 10 – A4010 Wycombe Road

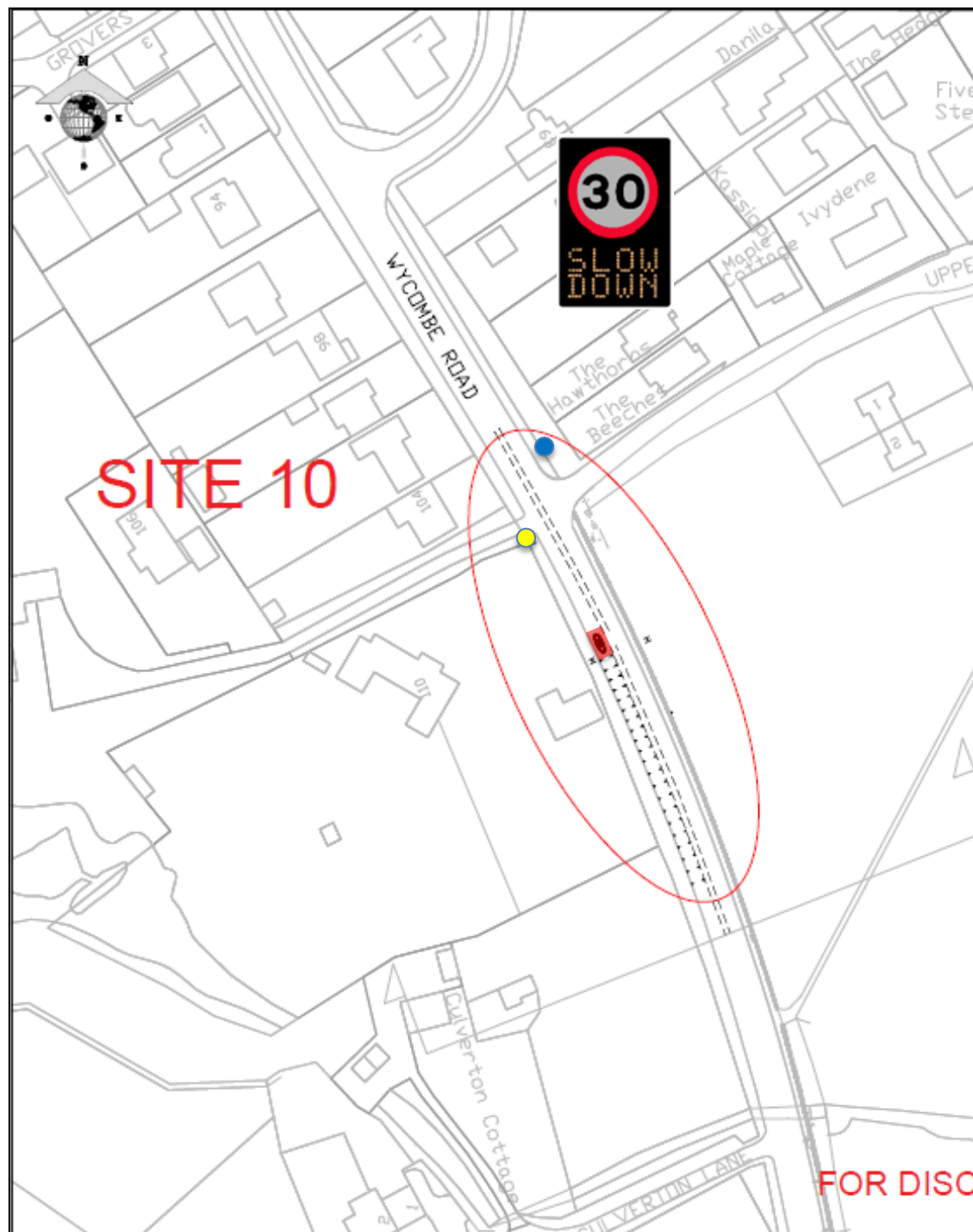

Site 10 – New Entry Feature

- New Vehicle Activated Sign (VAS) 30mph positioned in urban area
- New dragons teeth and high friction surfacing (HFS) feature
- Upgraded street lantern with 'Warm White' LED



FOR DISCUSSION ONLY

Site 4 – A4010 Bradenham Bends

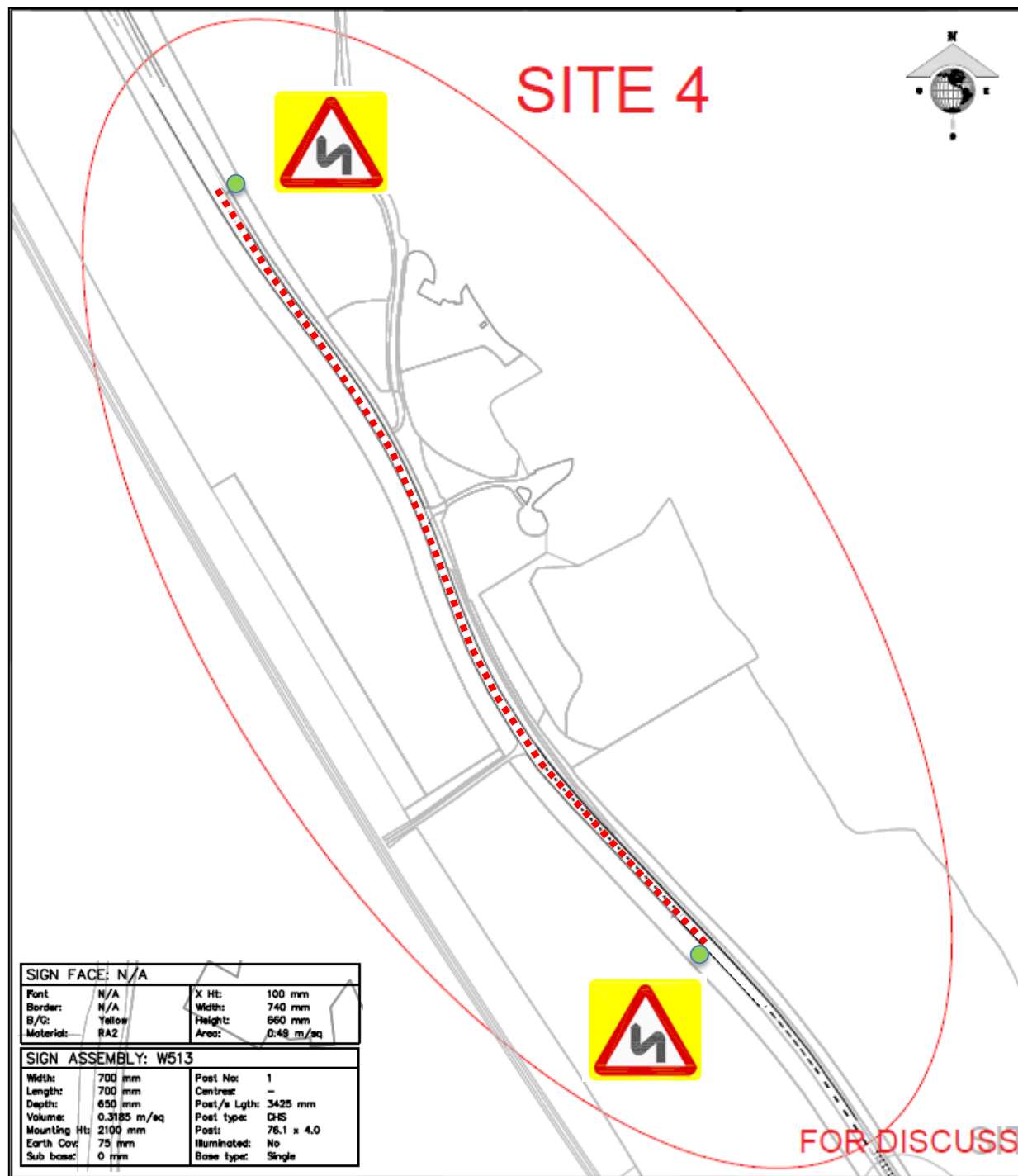

Site 4 – Bradenham Bends

- New yellow backed signage and road markings with 'SLOW' on approaches and carriageway edging lining.
- ■ ■ Replacement solar powered LED road studs between new static signs and road markings and edge lining.



FOR DISCUSSION ONLY

Site 14 – A4010 Bradenham Road Bus Shelter

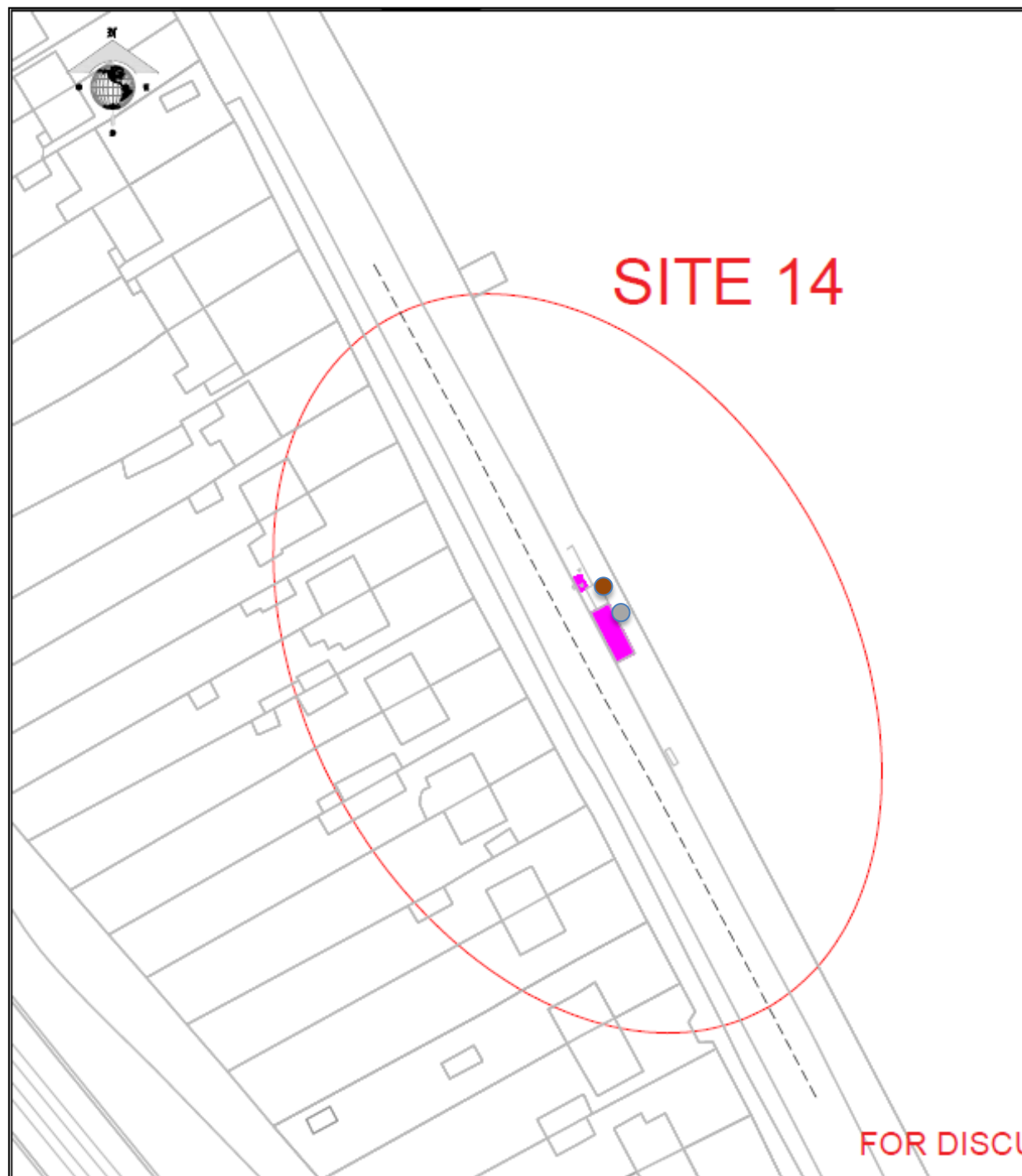

Site 14 – Bus Shelter

- New flexible construction hard standing
- New piped culvert and headwall to ditch line to support hard standing.
- Existing bus shelter repositioned further back from carriageway to increase space for waiting bus passengers.



FOR DISCUSSION ONLY

Site 13 – A4010 Bradenham Road

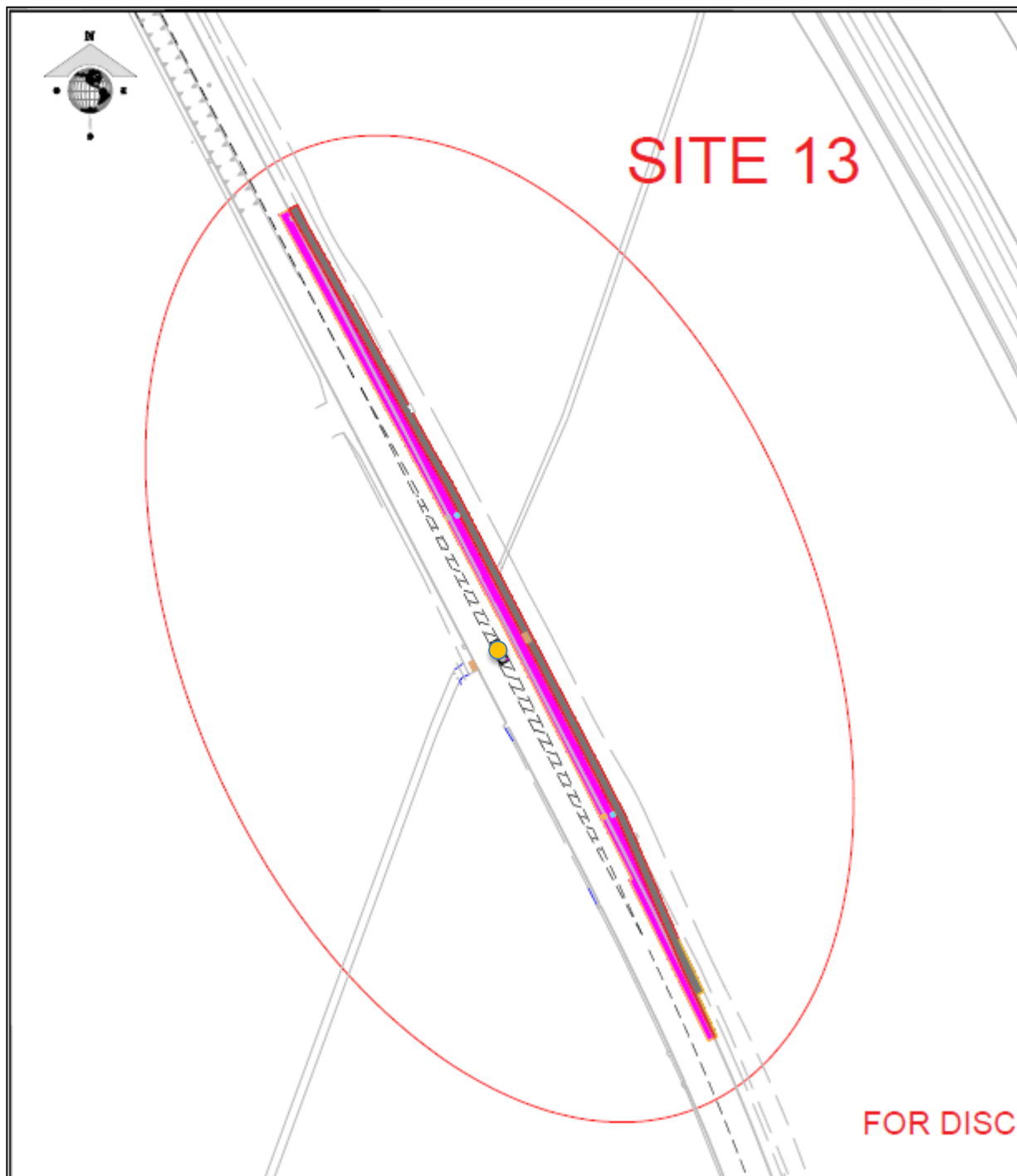

Site 15 – New Pedestrian Refuge

- New pedestrian refuge island with retro reflective signage and bollards
- Widening of footway
- Carriageway haunching and realignments



Example of a pedestrian refuge



FOR DISCUSSION ONLY

Site 16 – A4010 New Road (Booker)

Mount on new post in verge at 2.1m

SIGN FACE: W523.1			
Font:	Heavy	X Ht:	100 mm
Border:	Red	Width:	680 mm
B/G:	White	Height:	600 mm
Material:	RA2	Area:	0.41 m/sq

SIGN ASSEMBLY: W523.1

Width:	700 mm	Post No:	1
Length:	700 mm	Centres:	-
Depth:	650 mm	Post/s Lgth:	3425 mm
Volume:	0.3185 m/sq	Post type:	CHS
Mounting Ht:	2100 mm	Post:	76.1 x 4.0
Earth Cov:	75 mm	Illuminated:	No
Sub base:	0 mm	Base type:	Single

SITE 16

Mount on existing Street Lighting Column at 2.1m

SIGN FACE: W523.1			
Font:	Heavy	X Ht:	100 mm
Border:	Red	Width:	680 mm
B/G:	White	Height:	600 mm
Material:	RA2	Area:	0.41 m/sq

FOR DISCUSSION ONLY

Site 16 – New road signage and markings

- Proposed steep hill signage along A4010 New Road on approach to hill descent



Site 16 – A4010 New Road (Booker)

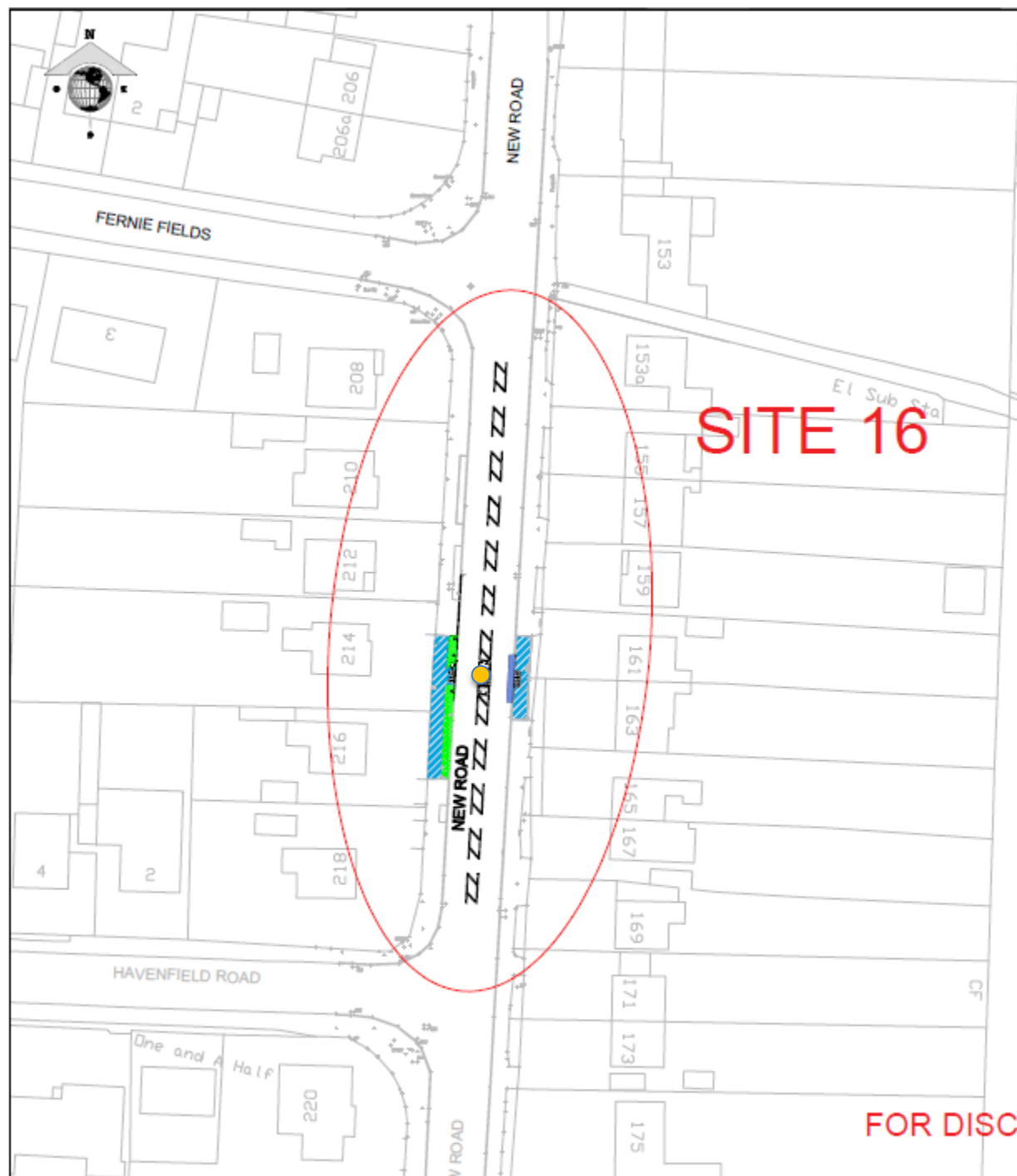

Site 16 – New Pedestrian Refuge

- New pedestrian refuge island with retro reflective signage and bollards
- Footway adjustments for tactile paving



Example of a pedestrian refuge



FOR DISCUSSION ONLY